

Can- Am Defender 2" Lift Kit Installation

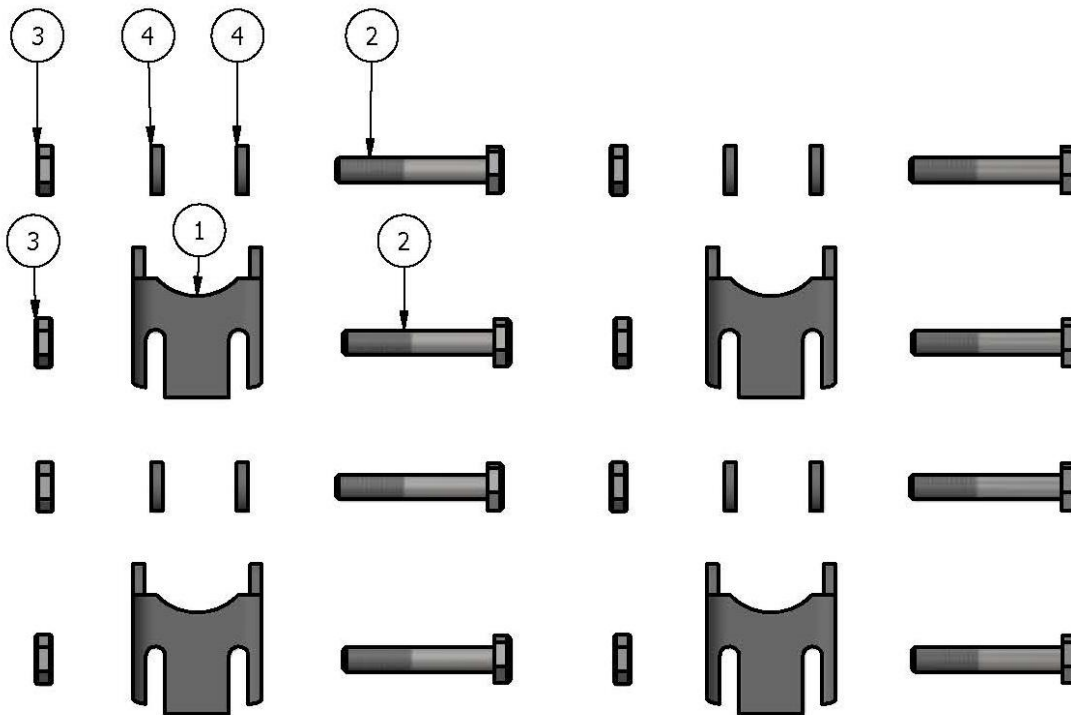

- 1) Remove hardware from box. Hardware supplied is shown below.
 Contains the following: (4) 2" Lift Brackets, (8) – M10- 1.5 x 60 mm Bolts, (8) – M10 Top Lock Distertd Lock Nut, and (8) ¼" Shock Spacers.



Parts List			
ITEM	QTY	PART NUMBER	DESCRIPTION
1	4	339-6120-00	Can-Am Defender 2" Lift Bracket
2	8	100-7510-02	M10 - 1.5 x 60 mm Bolt
3	8	100-7510-03	M10 Top lock Distertd Lock Nut
4	8	100-7510-01	Shock Spacer

Front

- 2) Lift UTV off the ground and support with jack stands.
- 3) With suspension at full drop remove the front lower shock bolts and set aside.
- 4) All 4 lift brackets are the same so location will not matter but Note that the short end of the Bracket will go to the inside of the UTV. With the shock pushed up out of the way install the lift bracket and insert 10m bolt and nut torque to 45ft-lbs. Move shock into location install 10m bolt and 2 of the $\frac{1}{4}$ " spacers 1 on each side between shock and lift bracket torque to 45ft-lbs. Repeat for other side.

Rear

- 5) Remove rear wheels and lower shock bolts.
- 6) Install lift bracket same as front with short end facing in. Install 10m bolt and nut torque to 45ft-lbs. Move shock into location install 10m bolt and 2 of the $\frac{1}{4}$ " spacer 1 on each side between shock and lift bracket Torque to 45ft-lbs.
- 7) Repeat for other side. Reinstall rear wheels and torque to factory specs. Note do to accessories that may be installed on your UTV adjusting of the shocks may be required to set proper ride height.

